



STD. Gain Horn Antenna

Specification

Model : MSGH137-20



Frequency Range (GHz)	5.85 - 8.20
Gain (dB)	20 Typ.
3dB Beamwidth (deg)	18 Typ.
Waveguide	WR137
Material	Al
Output	A Type: FDP70
	C Type: N-F or SMA-F
Size (mm)	A Type: 197 x 153 x 290
	C Type: 197 x 153 x 338
Net Weight (Kg)	A Type: 0.6 Around
	C Type: 0.7 Around

Outline Drawing (mm)

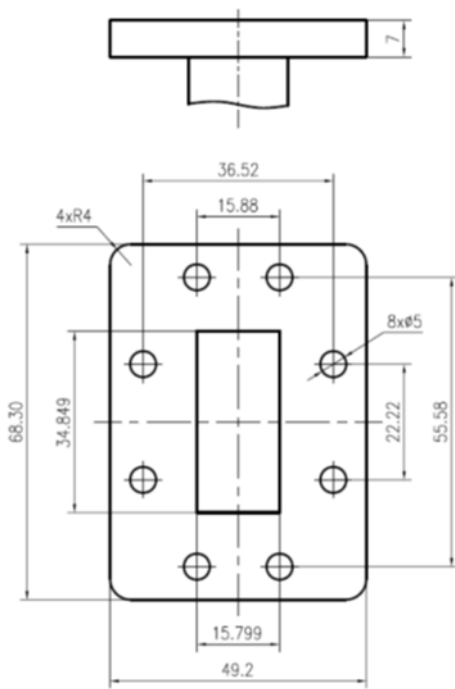

FDP70

A Type

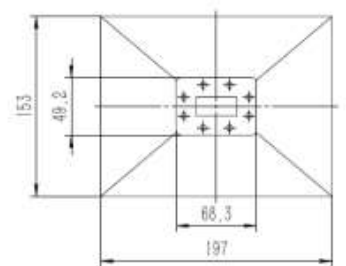
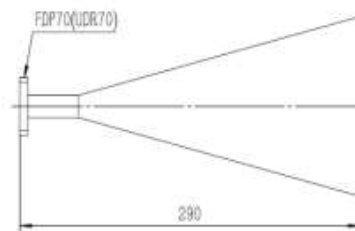

C Type

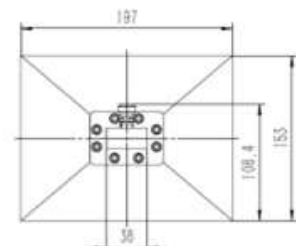
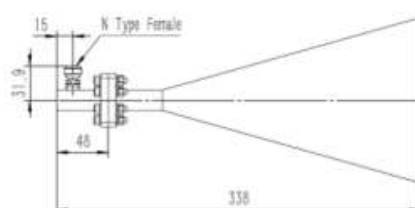

Antenna Gain (typ.)

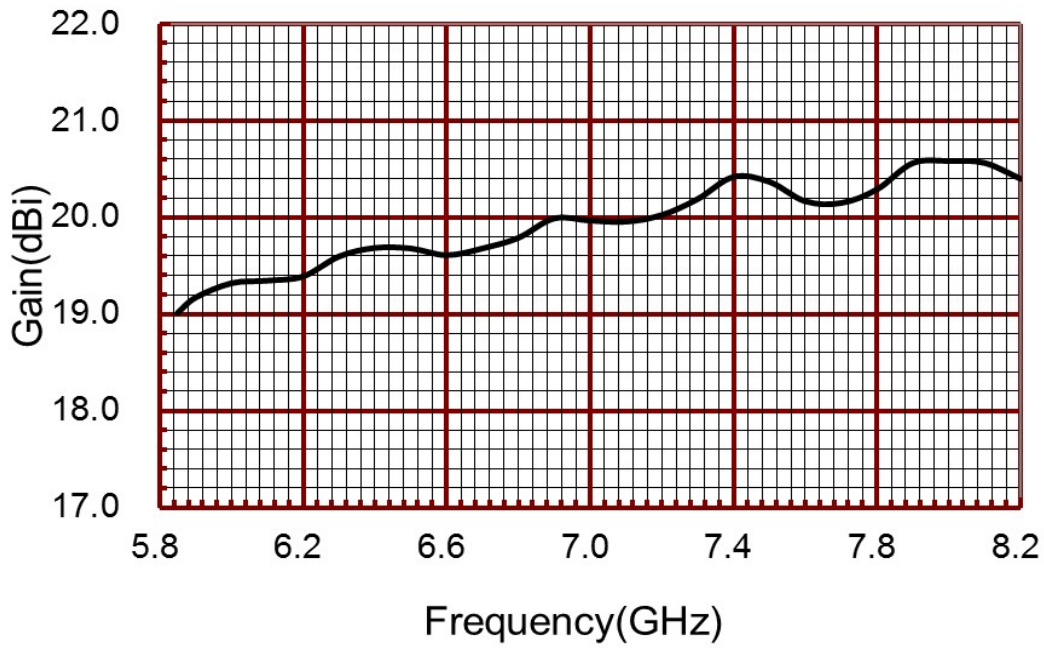

Antenna Factor (typ.)

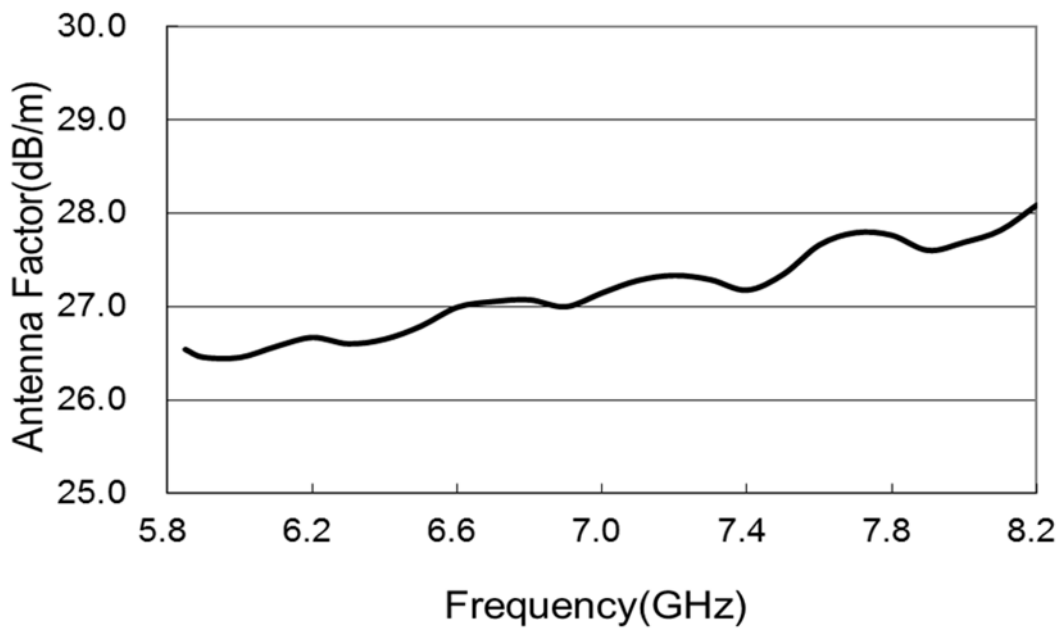

Radiation Patterns (typ.)

