

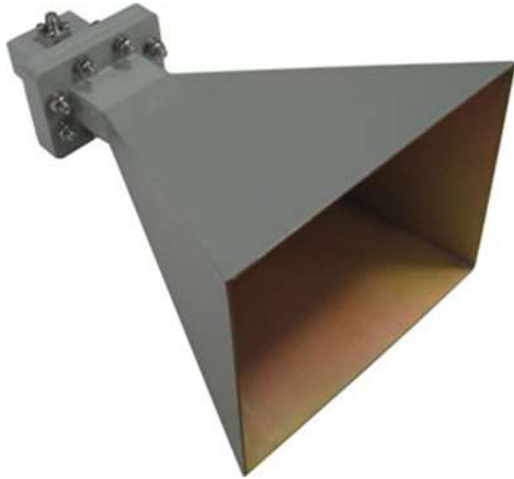

標準ゲインホーンアンテナ

製品概要



Model : MSGH137-15

Frequency Range (GHz)	5.85 - 8.20
Gain (dB)	15 Typ.
3dB Beamwidth (deg)	30 Typ.
Waveguide	WR137
Material	Al
Output	A Type: FDP70
	C Type: N-F or SMA-F
Size (mm)	A Type: 143 x 113 x 170
	C Type: 143 x 113 x 218
Net Weight (Kg)	A Type: 0.3 Around
	C Type: 0.4 Around

外形寸法図 (mm)

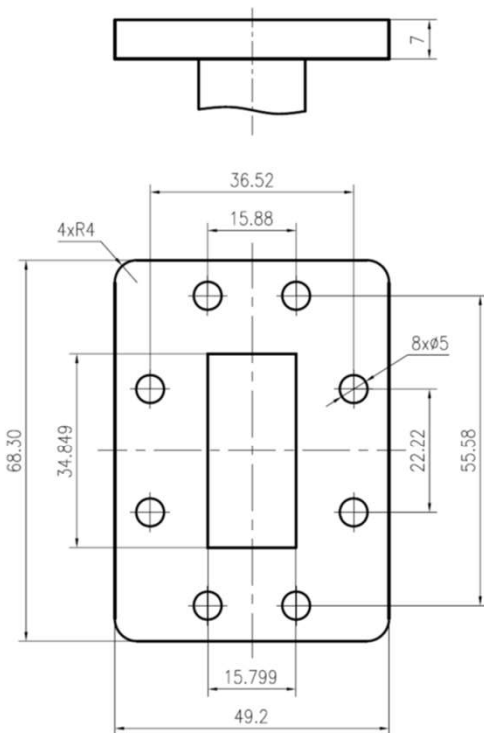

FDP70

A Type

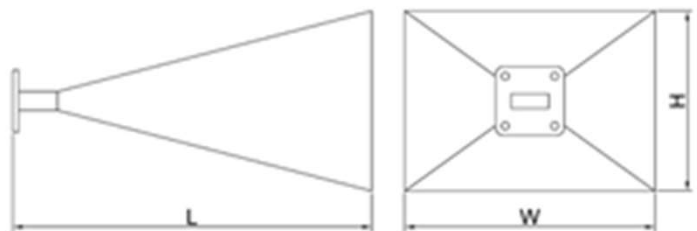

W x H x L: 143x113x170

C Type



W x H x L: 143x113x218

アンテナ利得 (Typ.)

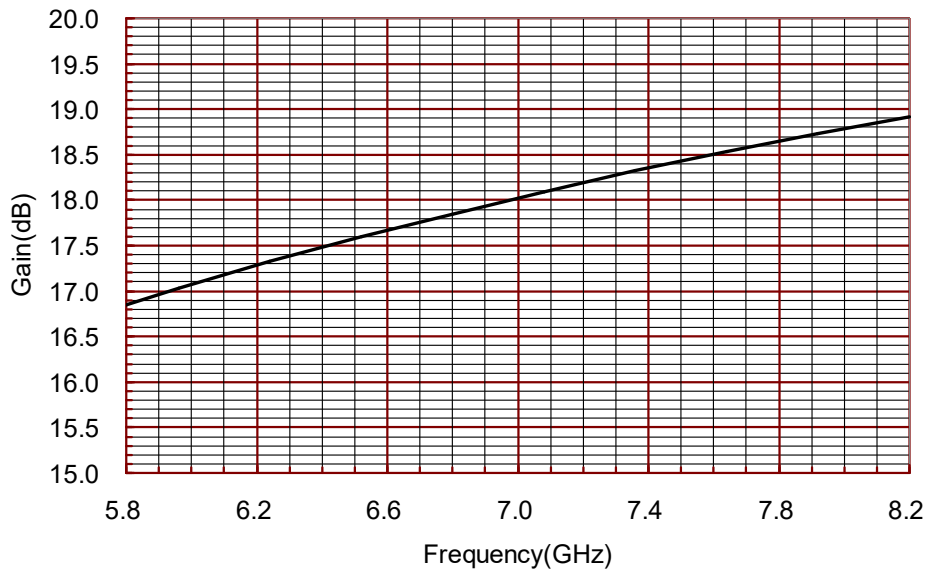

放射パターン (Typ.)

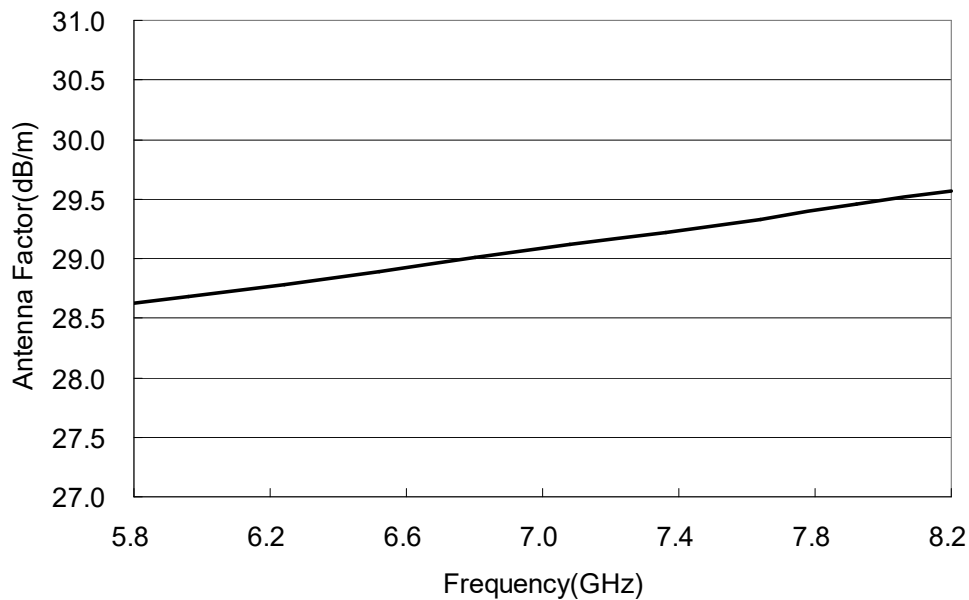

直行偏波分離 (mm)

